

# LARYVOX® PRO HME / PRO HME HIGHFLOW

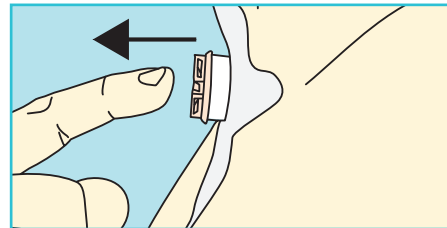

- ▶ HME with hygienic finger occlusion and hermetic sealing to facilitate speech
- ▶ The finger occlusion plate is guided by a mounting bail to assure an even and planar occlusion of the HME even if the finger is not placed in a 100% centered position
- ▶ Guidance by the mounting bail further prevents the HME foam from being squeezed by the occlusion process and thereby largely reduces extrusion of humidity/secretions
- ▶ Very good haptic feeling of the final closing point of the occlusion plate (stopper point)
- ▶ A sealing device at the bottom of the HME (opposite of the finger occlusion plate) assures hermetic sealing to facilitate flawless speech-option and protects the filter from mucus secretions. This may result in the patient needing less cassettes during the day.
- ▶ Air enters/exits through frontal and lateral openings so LARYVOX® PRO HME can even be operated through the patient's clothing
- ▶ A rabbet around the housing facilitates an easy grip of the HME to remove it quickly from the base plate (for example in case of coughing)
- ▶ With 22 mm adapter (KOMBI) to connect to any conventional base plates (e.g. LARYVOX® Tape) or silicone tubes for laryngectomees (e.g. LARYNGOTEC®)
- ▶ Two variants: Standard and HighFlow for reduced airway resistance

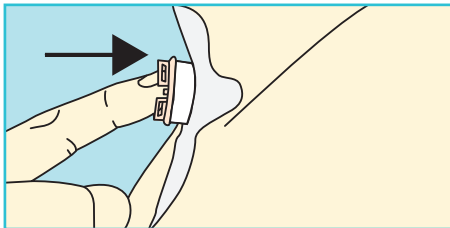

- ⊗ Do not reuse
- ☂ Keep dry
- ☀ Keep away from sunlight
- 📖 Consult instructions for use
- CE CE marking

## Order information:

**LARYVOX® PRO HME, Pack of 30**

**REF 49841**

**LARYVOX® PRO HME HighFlow, Pack of 30**

**REF 49840**