

OPTIBRUSH® CONT

Cannula Cleaning tub with Sieve Insert

- ▶ Cleaning Tub, made of plastic material
- ▶ Large diameter (10 cm), to allow the cleaning of standard tracheostomy tubes
- ▶ The OPTIBRUSH® CONT Cleaning Box contains a removable sieve insert which allows the tracheostomy tube to be gently agitated in the cleaning solution.

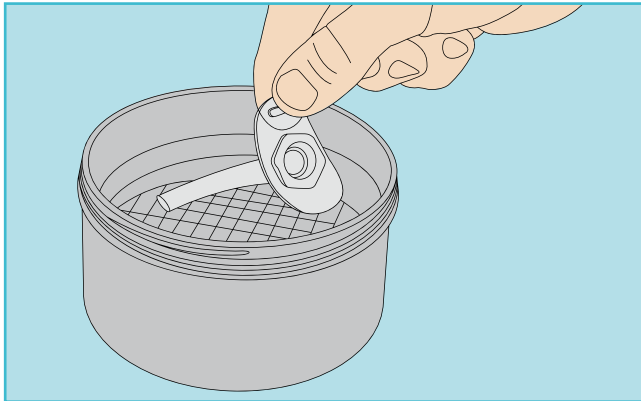

Consult instructions for use



CE marking

Order information:

OPTIBRUSH® CONT

REF 31200